



Low Flow Handheld Shower Head Kit

Installation Instructions:

Step 1: Remove the existing shower head from the shower arm.

Step 2: Clean the threads on the shower arm with a small wire brush or scrubbing sponge to remove any residual PTFE tape or old joint compound. Wrap the threads clockwise with 2 turns of new Teflon tape.

Step 3: Ensure the washer ① is positioned flat and straight inside the ball-joint ② of the bracket. Turn the bracket clockwise to the shower arm. Do not over tighten.

Step 4: Put the handheld shower head ③ on the holder ④ of the bracket.

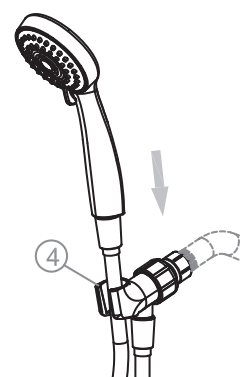
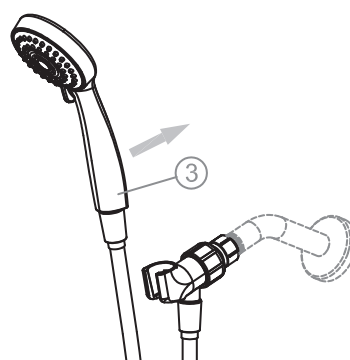
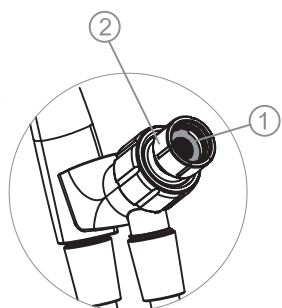
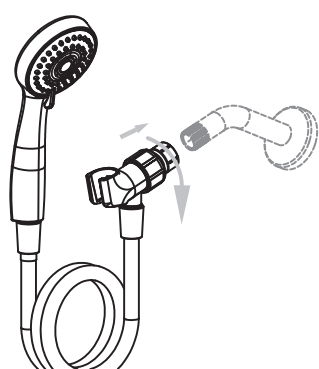

Step 5: Turn on the water to check for leaks and gently tighten any coupling if you notice water dripping. Do not over tighten.

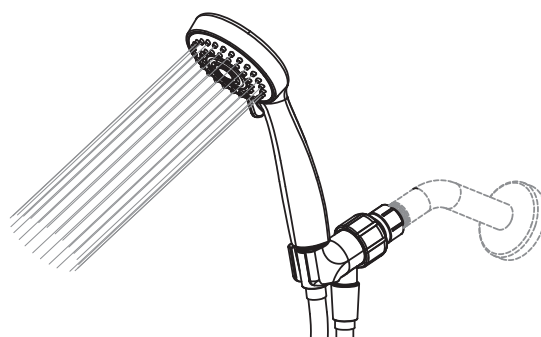

LIMITED WARRANTY: This product is warranted to be free from defects in workmanship and material for 1 year. If it fails to do so, Greenlite™ will send you, at its election, a replacement product or refund your original purchase price upon receipt of the returned product, register receipt and proof of purchase. Please call (844) 695-9090 to find out how to return the product. Do not return this product to the retailer. This limited warranty does not cover product subject to accident, neglect, abuse, misuse or acts of God. Replacement or refund is your sole remedy.

For all enquiries, please contact our customer service team at info@greenliteusa.com or 1-844-695-9090 from 9:00 AM to 5:00 PM EST

www.greenliteusa.com
V1-11022021

210*280mm

材质：70g双胶纸