



Model NO. 23W/SHOP/1T



LED Shoplite Fixture

General Safety Information (Please see the reverse for Installation Instructions)

READ AND FOLLOW SAFETY INSTRUCTIONS DISCONNECT POWER BEFORE INSTALLATION

To reduce the risk of personal injury or property damage from fire, electric shock, falling parts, cuts/abrasions, and other hazards, read all warnings and instructions included with and on the LED Shoplite box and all LED Shoplite labels.

THIS DEVICE IS NOT SUITABLE FOR USE WITH DIMMERS.
THIS DEVICE IS SUITABLE FOR USE IN DAMP LOCATIONS.

WARNING:

Risk of electric shock or fire. Do not use with an extension cord near water or where water may accumulate. Keep the LED Shoplite at least 16 feet away from pools and spas. Keep the plugs and receptacles dry.

- Turn off the switch and circuit breaker before installing.
- Install directly beneath a ceiling-mounted receptacle.
- Not intended for recessed installation.
- Use only insulated staples or plastic ties to secure the cord.
- Do not install directly over a heat source (stove, etc.)
- Installation should not be made on a radiant-heating ceiling.
- Injury to people and damage to the fixture and/or mounting surface may result if the fixture is pulled from the surface. To reduce the likelihood of such injury or damage, mount only on a mechanically sound surface.
- Do not alter the plug or power supply cord in any way or try to install this product in any other method besides method shown on this sheet.

NOTICE:

This device complies with Part 15 of the FCC Rules. Operation is subject to the following two conditions:

(1) This device may not cause harmful interference, and (2) this device must accept any interference received, including interference that may cause undesired operation.

Care & Cleaning

CAUTION: Disconnect the power before attempting to clean the fixture. Greenlite's LED Shoplite is manufactured from quality materials that last many years with minimum care. It is recommended to periodically clean the diffuser and the interior of the fixture using a mild, non-abrasive glass cleaner and a soft cloth. **DO NOT use solvents or cleaners containing abrasive agents.**

LIMITED WARRANTY:

This product is warranted to be free from defects in workmanship and material for 5 years. If it fails to do so, Greenlite™ will send you, at its election, a replacement product or refund your original purchase price upon receipt of the returned product, register receipt and proof of purchase. Please visit www.greenliteusa.com to find out how to return the fixture. This limited warranty does not cover fixtures subject to accident, neglect, abuse, misuse or acts of God. Replacement or refund is your sole remedy.

For all enquiries, please contact our customer service team at:
info@greenliteusa.com or 1-877-255-0004 from 9:00 AM to 5:00 PM EST.

Please see the other side for Installation Instructions

LED Shoplite Fixture

Installation Instructions (Please see the reverse for General Safety Information)

Parts included in the package:
LED luminaire X1, Screw hook X2, Plastic anchor X2,
hanging chain X2, double-sided adhesive foam X3

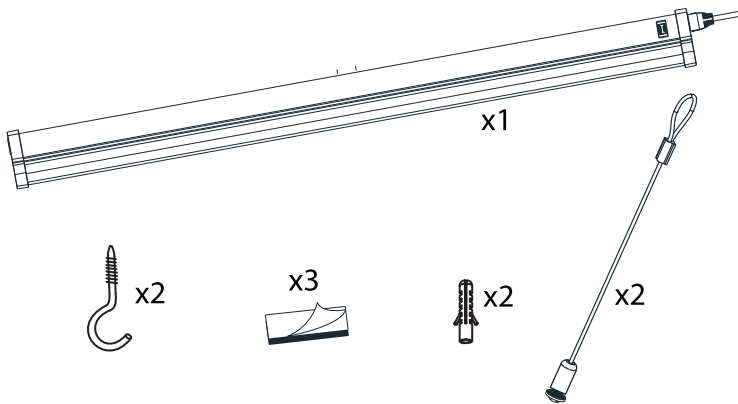

1. Drill two 1/4" holes in the drywall surface 42-3/4" apart, Install the two plastic anchors inside the two drilled holes, then screw the hook into each anchor. If the mounting surface is solid wood, just drill two 1/16" pilot holes 42-3/4" apart, then screw the hook into holes. Please make sure the switch on the light can be easily accessed.

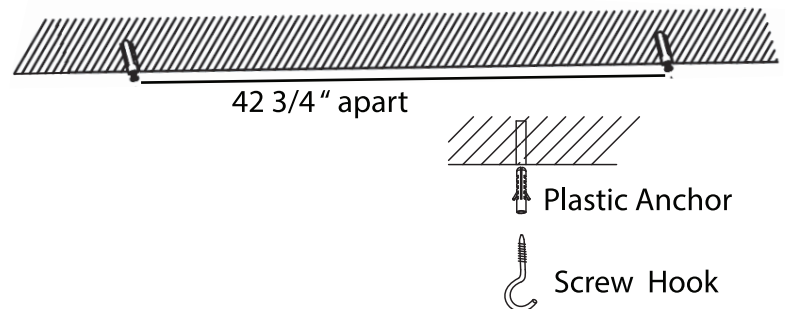

2. Insert the screw head inside the groove of the lighting header. Screw the pendant on the chain to the screw.

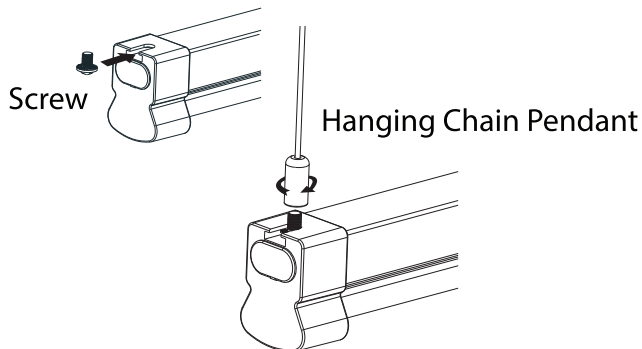

3. Attach the chain to the two hooks mounted on the mounting surface.

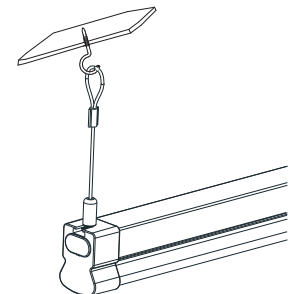

4. After installation, plug the power cord (B) into the end of the light, then into the power supply. Turn on the switch (C) on the light.

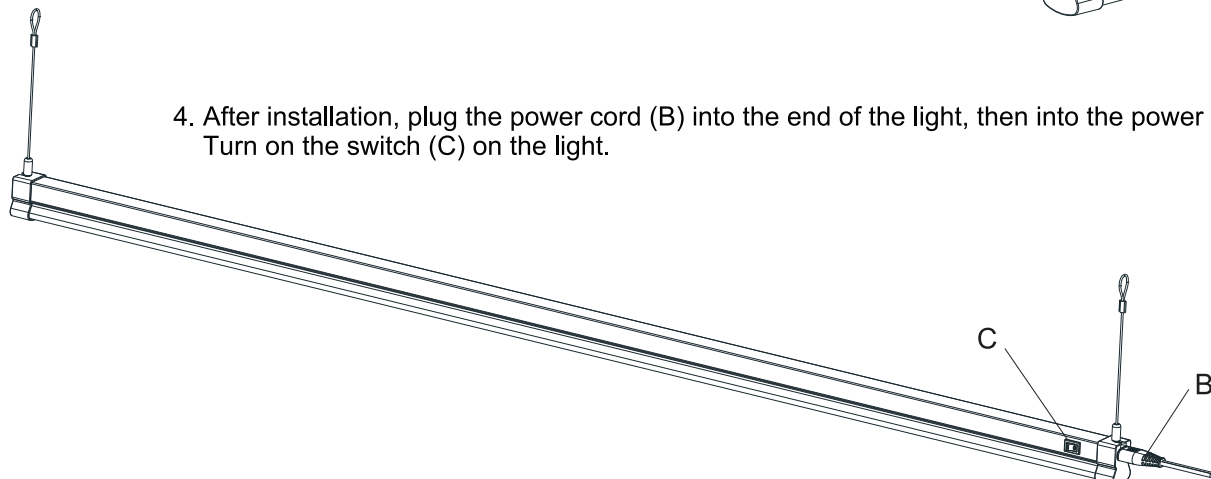

LED Shoplite Fixture

Optional Surface Mounting - Installation Instructions

- Securing fixture to surface** Place the double sided tape on the LED Shoplite. Remove double sided tape backing and press lightly to install on the mounting surface.

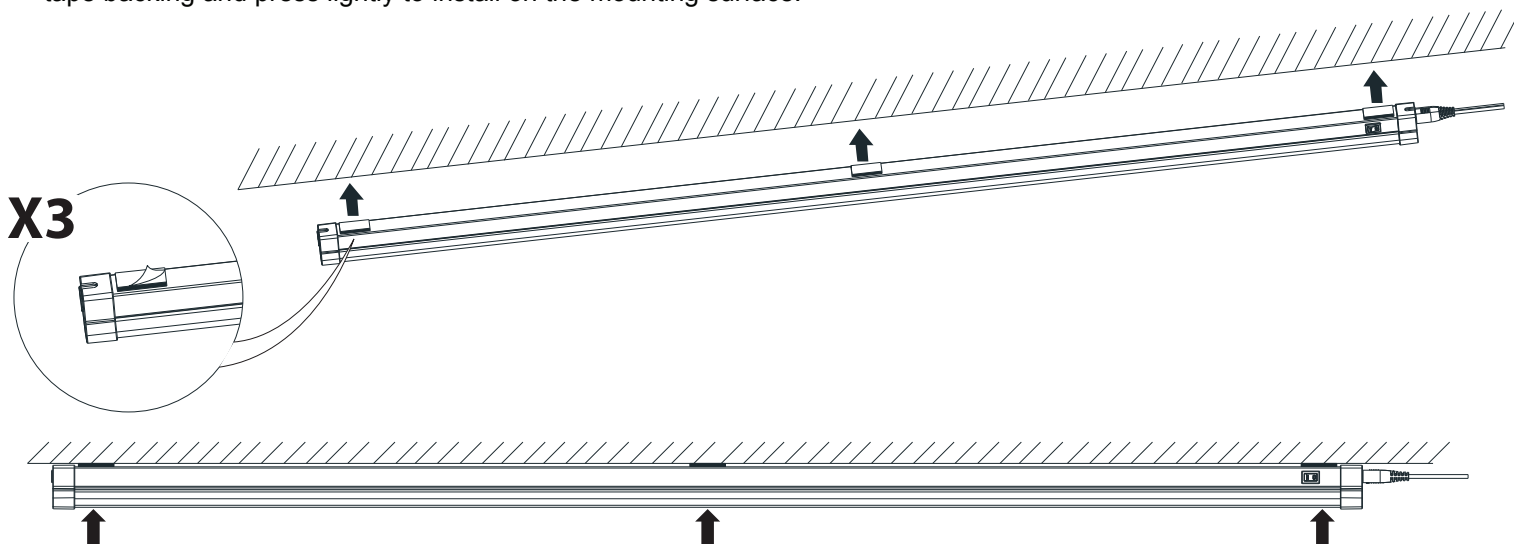

Please check with your local inspector to insure this mounting method meets local requirements.

LUMINOUS INTENSITY DISTRIBUTION DIAGRAM

